

- SEWER IN REAR -

MICROFILMED

CREEKSIDE VILLAS P.U.D.
PHASE II

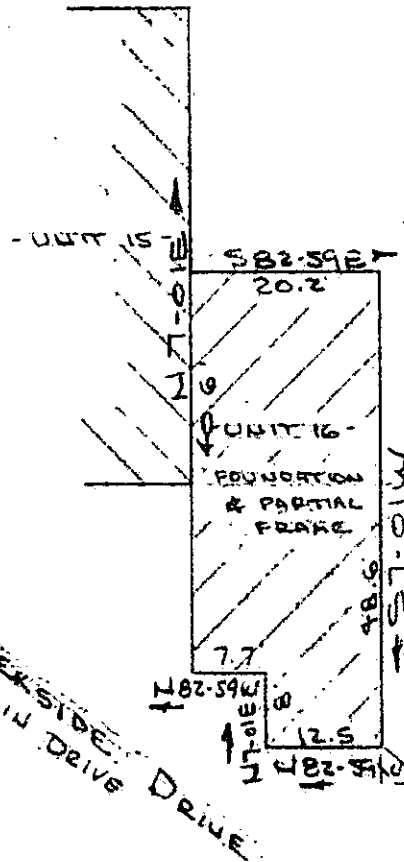
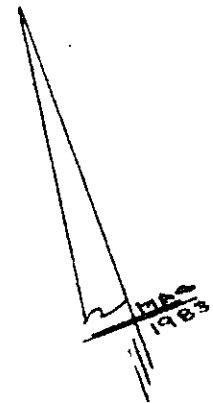

- WATER & SEWER AVAILABLE -

UNIT 17
PROPOSED

Note:
Improvements
on this lot
are not in
flood
hazard
area
GREENVILLE CO. S.C.
DEC 20 12:02 PM '84
DONNIE S. TANKERSLEY
R.M.C.

CREEKSIDE DRIVE
WATER IN DRIVE

PHASE II
DIVISION
LINES
PHASE III

PROPERTY OF
CREEKSIDE DEVELOPERS
NEAR GREENVILLE S.C.
SCALE: 1"=20' 30 NOV 1984

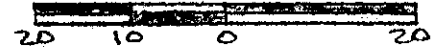

DEC 20 1984

This is to certify that on the 30th day of November, 1984, I surveyed the property shown on this plat, being known as UNIT 16 on plat of CREEKSIDE VILLAS P.U.D. PHASE II and recorded in the RMC Office Greenville County, S. C., in Plat Book " 9 - W " at Page 79; and that the property lines, walls and buildings are as shown hereon, and that the walls and buildings located on said lot do not encroach or project on adjacent street or property, and that no adjacent walls or buildings encroach or project on said premises, and no power lines cross this property except as shown hereon.

11-D-65
18643

R. B. Bruce
R. B. Bruce, RLS # 2952

CAROLINA SURVEYING CO.
112 Manly St.
Greenville, S. C.

Recordable Plat

2 DE 20 84 716 3.000CI